

MODEL KIT, MODÈL RÉDUIT, MODELLBAUSATZ

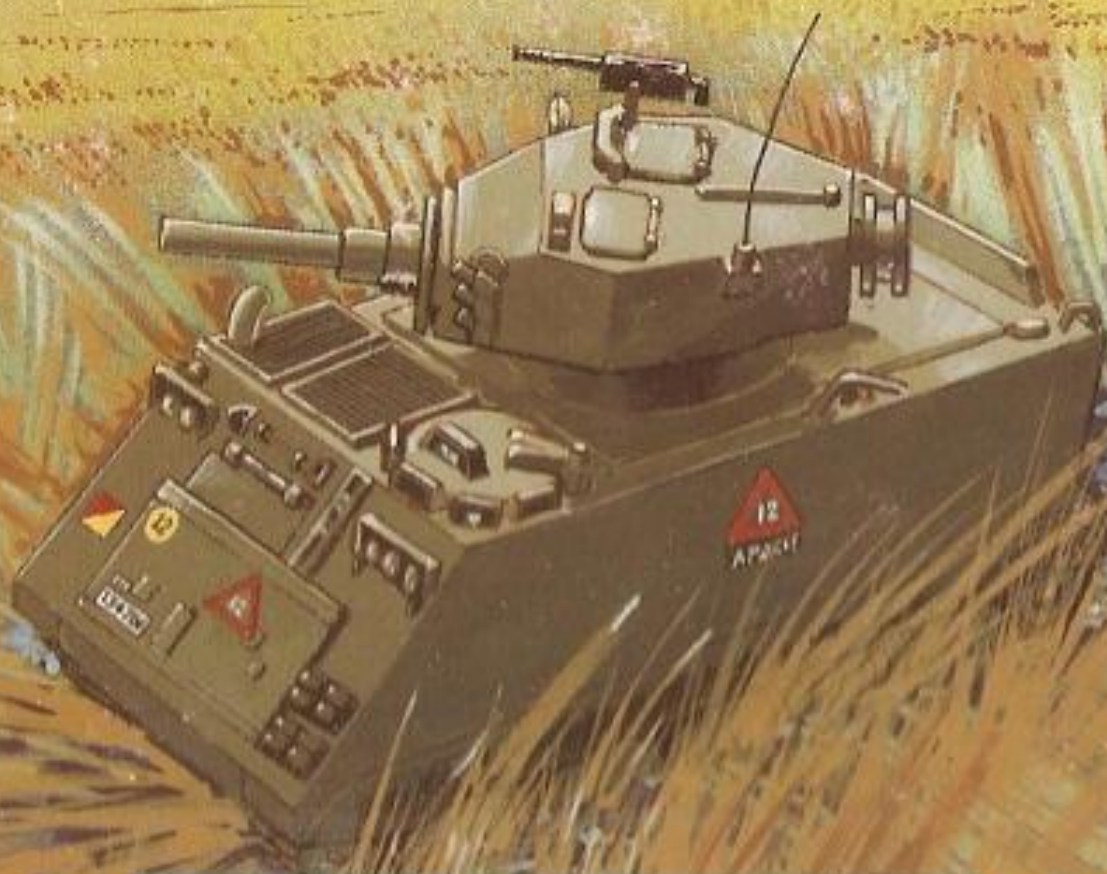

MALT HOUSE VINTNERS

£4.20



**M.113. FIRE SUPPORT  
VERSION**

JB1006  
'MADE IN ENGLAND'

1:76 SCALE  
1:76 MASSTAB  
1:76 ECHELLE

JB1006. M.113: FIRE SUPPORT VERSION

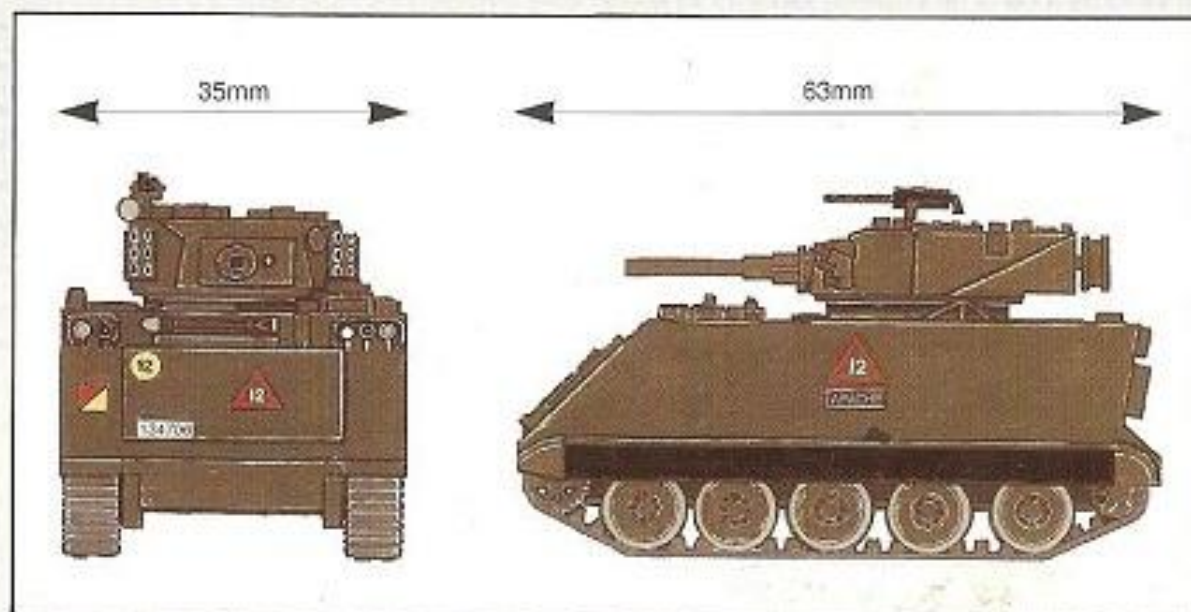

Made in England by:  
J.B. MODELS  
18 Sandall Road  
Wisbech  
Cams. PE13 2RS  
Please retain address for reference  
© Copyright J. B. Models 1996



37 PIECES



8+



5 025795 900064 >



1/72 Scale Construction Kit.

## **M.113 F.S.V.**

Australian Fire Support Vehicle.

Developed during the fifties the M.113 entered service with the American army in 1960 and by the time of the American involvement in the Vietnam War it was the standard squad transport. It was also supplied to a number of Americas allies during this conflict, including Australia.

The initial use of the M.113 in Vietnam showed a need for increased fire power and protection for the crew. A number of different turrets were developed and tried out in order to overcome this problem. The Australian army experimented with fitting the turrets from obsolete Saladin armoured cars to 18 of their M.113's which resulted in the Fire Support Version.

This involved plating over the deck of the vehicle and fitting the driver with a lift and twist hatch, together with a number of minor modifications to the layout of the vehicle. The addition weight of the turret resulted in excessive wear on the running gear and buoyancy problems, overcome by an extension to the trim vane.

- Length : 4.86m.
- Width : 2.68m.
- Weight : 11,930 Kg (unladen).
- Max. Speed. : 60 km / hour. (on roads).
- Power Unit. : G.M.C. 6V53 diesel engine.
- Armament : 76 mm L5A1 Gun with a 7.62 mm coaxial machine gun and a pintle mounted 7,62 mm machine gun fitted to the commanders cupola  
2 x 6 barrellled smoke discharges.

Made in Great Britain by J. B. MODELS.

P.O. Box 12, Deeping St James.

Peterborough, PE6 8PL.

In case of complaint please write to the above address.

# Assembly Instructions

Cut parts from frame with a sharp knife. Paint interior and small detail before assembly.  
 Test fit parts before cementing. Assemble in sequence shown. Part numbers in circles.



Cement parts together



Optional parts



Completed sections

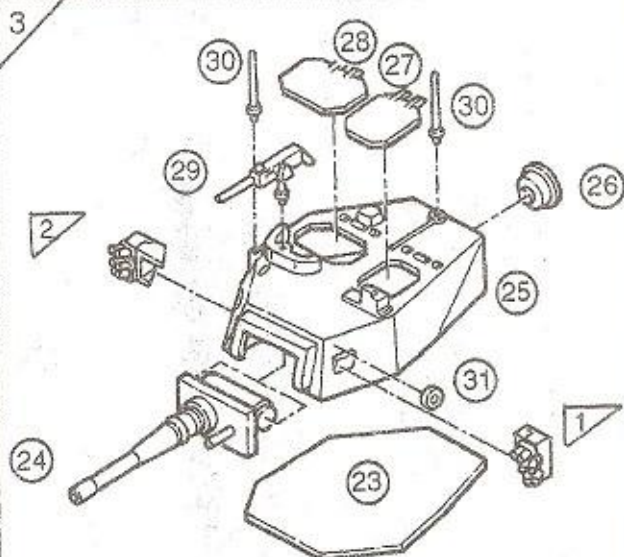
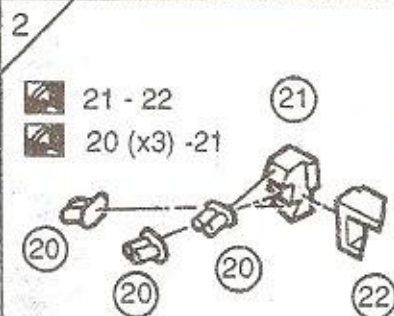
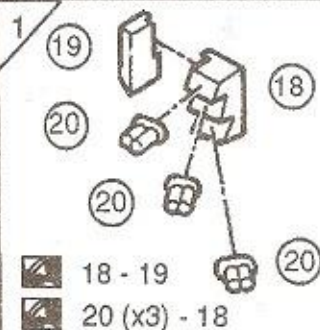

- 23 - (24 DO NOT CEMENT) - 25
- 1 - 25
- 2 - 25
- 26, 27, 28, 29 - 25
- 30 (x2) - 25
- 31 - 25

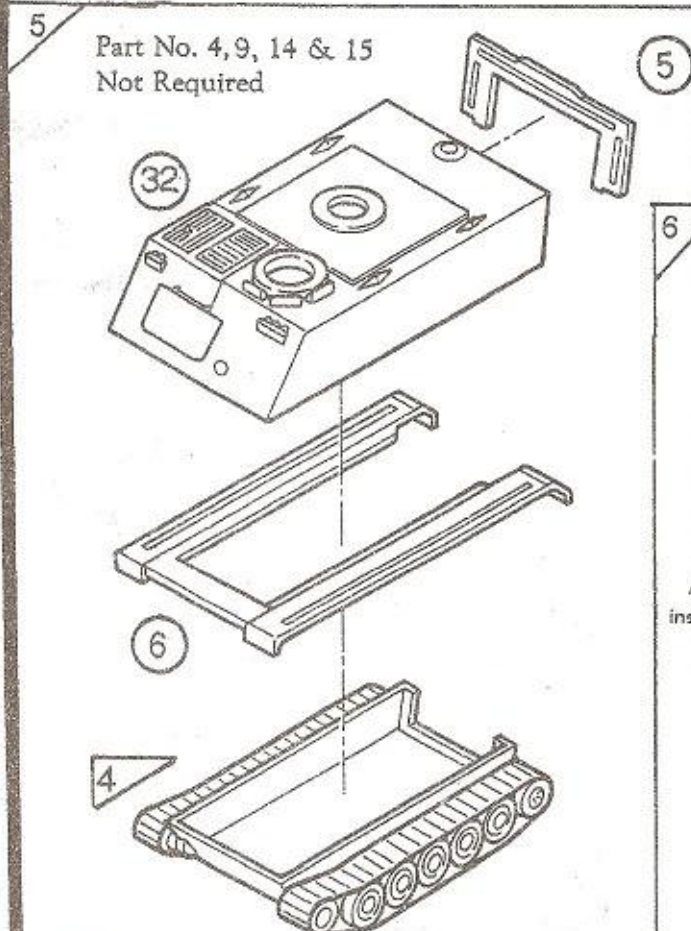
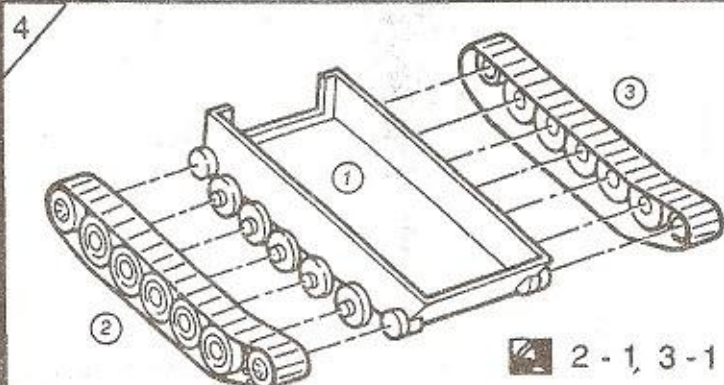

- 5 - 32 6 - 32
- 6 - 4

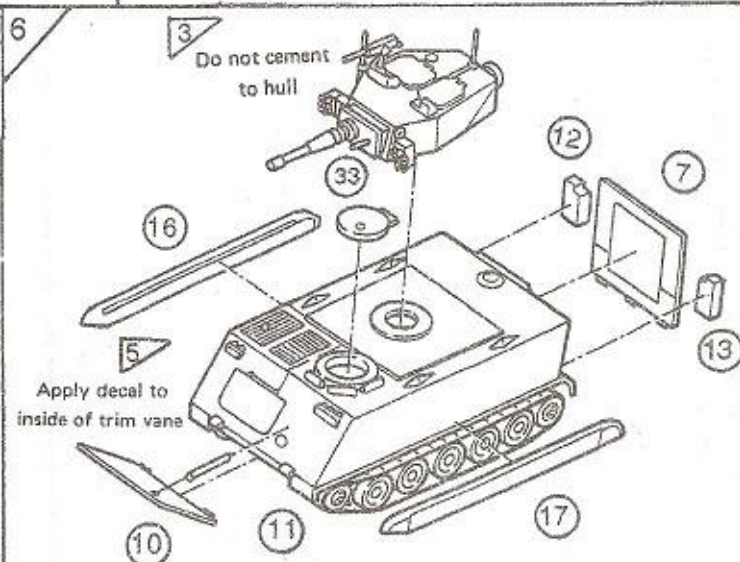

To model the trim vane in the lowered position, omit part 11 and cement part 10 flat against the hull front.

- 11 - 10 -
- 7, 8, 12, 13, 33 - 16, 17 -

## COLOUR SCHEMES

**1**

**134706**

Numbers in circles indicate colour from paint guide.

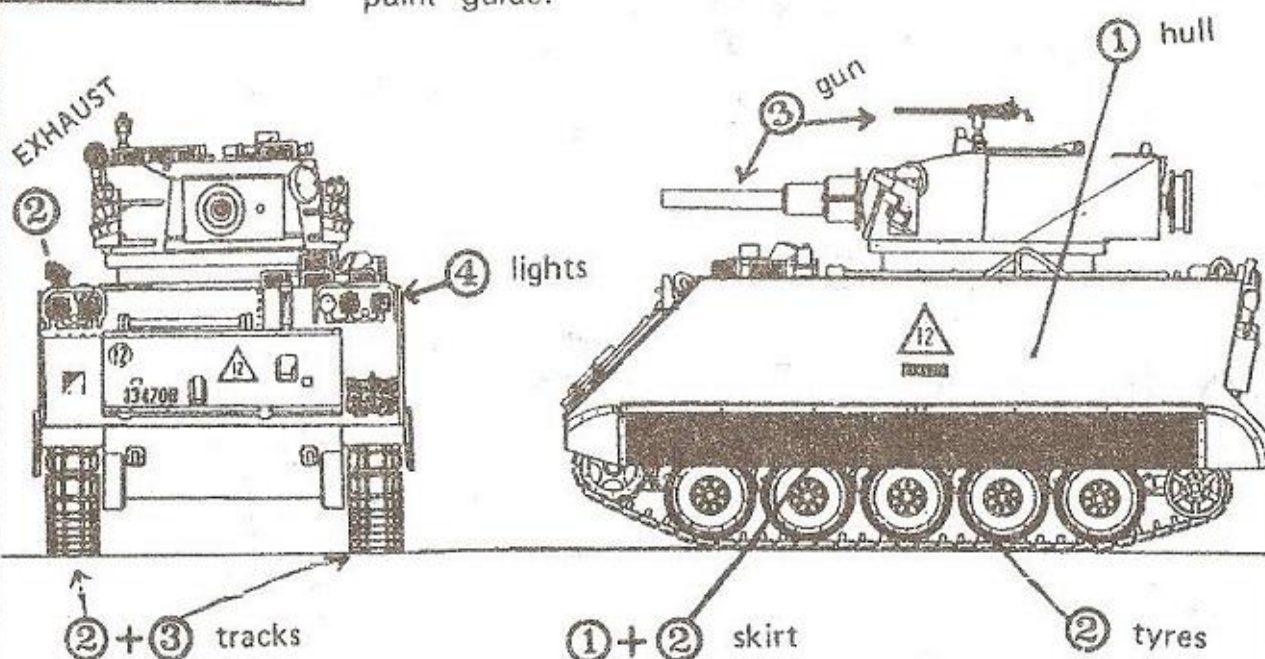

**2**

**134700**

Colours As scheme No. 1

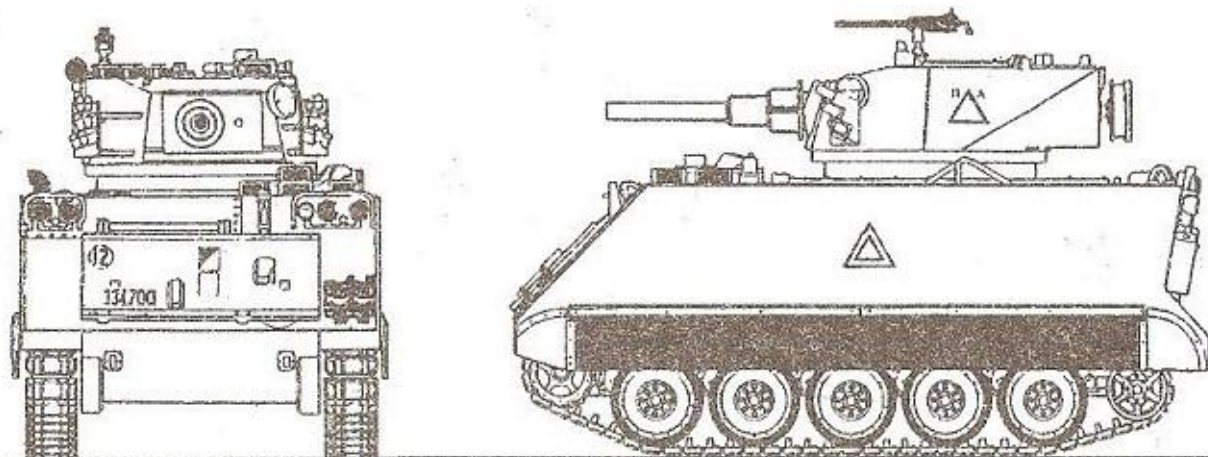

### PAINT GUIDE

### DECALS

No	Colour & Humbrol Ref. No.
1	Matt Dark Green 30
2	Matt Black 33
3	Gun Metal 53
4	Silver 11

Select version.

Trim decals to size, place onto clean water for 45 seconds (approx), slide into position and pat dry. The finished model can be suitably weathered to complete.

1



APACHE



APACHE



134706



2



134700



COMMON



12

J.B.1006 M.113 F.S.V.